

# PRESTRESSED CONCRETE CONSTRUCTION

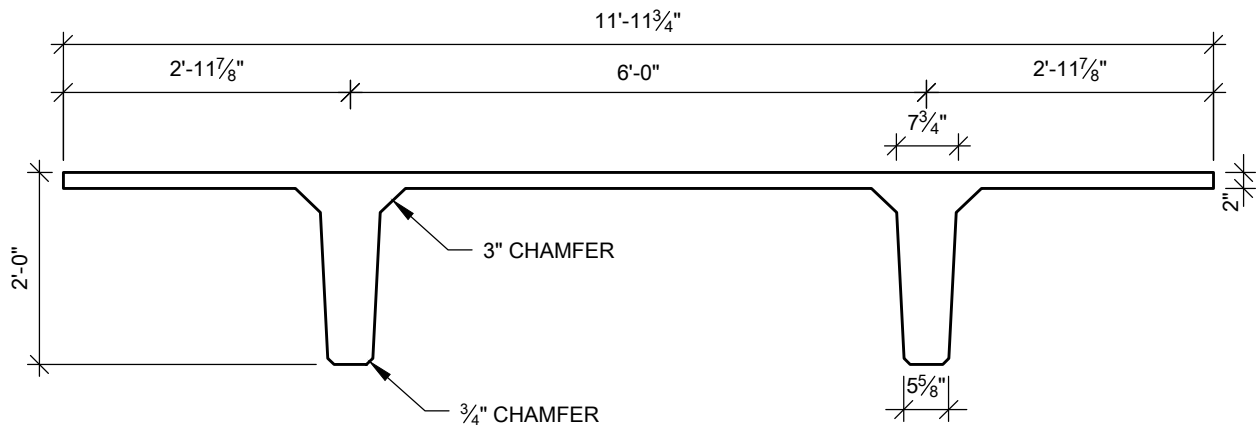

P.O. Box 311 - Newton, Kansas 67114  
Phone: 316-283-2277 Fax: 316-283-2321  
[www.preconc.com](http://www.preconc.com)

## 12'-0" DOUBLE TEE 24" DEEP



### SECTION PROPERTIES

WT = 632 plf  
A = 607 in<sup>2</sup>  
Y<sub>t</sub> = 6.70 in  
Y<sub>b</sub> = 17.30 in  
S<sub>b</sub> = 1,813 in<sup>3</sup>  
S<sub>t</sub> = 4,682 in<sup>3</sup>  
I = 31,368 in<sup>4</sup>